

REASSEMBLY

1. INSTALL COLLARS AND BUSHINGS

2. ASSEMBLE SHIFT LEVER SUB-ASSEMBLY

- Apply MP grease on the detent rod and shift lever sub-assembly.
- Install the wire guide, wire guide No.2 and detent rod.
- Insert the grooved pin in the detent rod pin hole.
- Aligning the grooved pin with the notch of the guide hole.

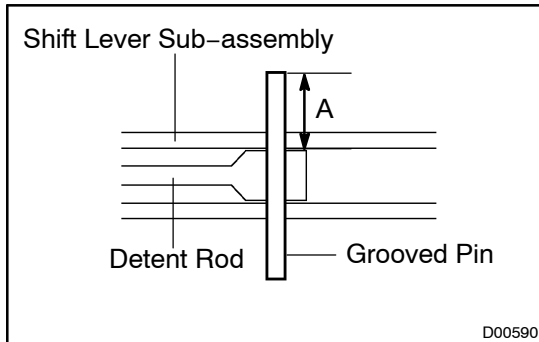

- Using a hammer, install the grooved pin.

A: 13.5 ± 0.3 mm (0.531 ± 0.012 in.)

NOTICE:

When pressing in the grooved pin at the place other than the notch, there may be fear of damaging the shift lever sub-assembly.

- Check the detent rod operation.
- Install the spring and shift lever sleeve.
- Apply MP grease on 2 bushings and install 2 bushings to shift lever sub-assembly.

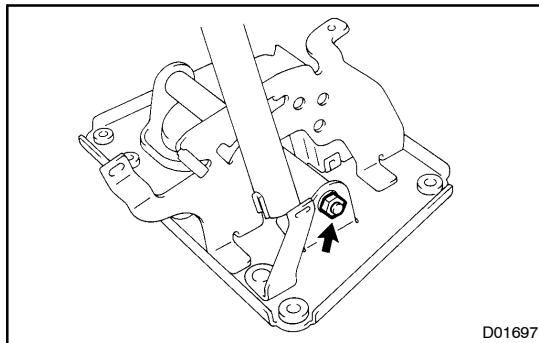

3. INSTALL SHIFT LEVER SUB-ASSEMBLY

- Install the shift lever sub-assembly to shift lever plate with the control rod and nut.

Torque: 13 N·m (130 kgf·cm, 9 ft·lbf)

- Install the shift lever boot and 3 collars

4. INSTALL SHIFT LEVER STOPPER

5. INSTALL SHIFT LOCK UNIT

- Install the shift lock solenoid bracket with the 2 screws.

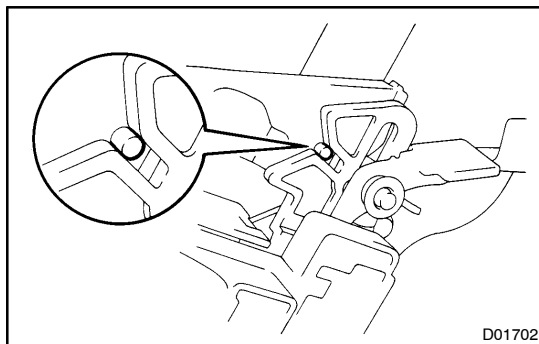

- Install the shift lock control ECU.

NOTICE:

Install the grooved pin into the groove of the shift lock unit as shown in the illustration.

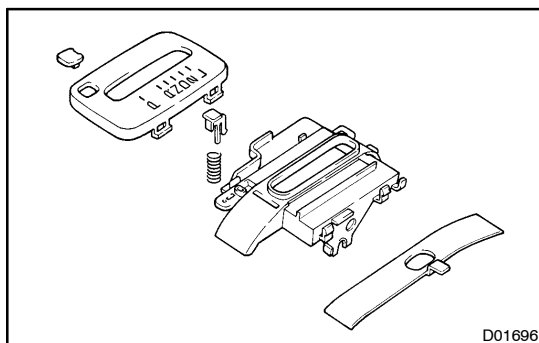

6. ASSEMBLE INDICATOR HOUSING

- Install the shift lock release button and spring to the position indicator lower housing.
- Install the position indicator slider cover to the position indicator upper housing.
- Install the position indicator lower housing to the position indicator upper housing.
- Install the shift lock release button cap to the indicator housing.

7. INSTALL INDICATOR HOUSING

Install the indicator housing with the screw.

8. INSTALL INDICATOR LIGHT

- (a) Install the bulb and cap to the indicator light wire.
- (b) Install the indicator light to the indicator housing.

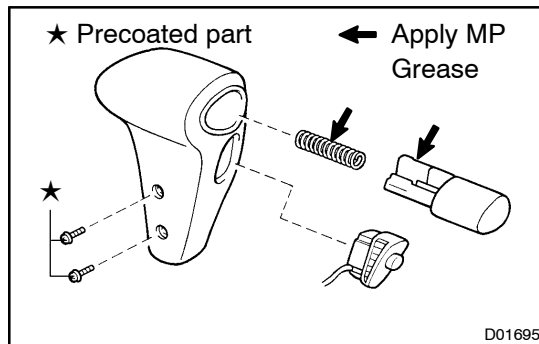
**9. INSTALL SHIFT LEVER KNOB**

- (a) Apply MP grease to shift lever knob button.
- (b) Install the spring and shift lever knob button to shift lever knob.
- (c) Install the shift lever knob to shift lever sub-assembly.
- (d) Install the O/D main switch to shift lever knob.
- (e) Coat the threads of the 2 screws with sealant.

Sealant:

Part No. 08833-00080, THREE BOND 1344, LOCATE 242 or equivalent

- (f) Install the shift lever knob and 2 screws to shift lever sub-assembly.

NOTICE:

Make sure not to catch O/D main switch wire harness.

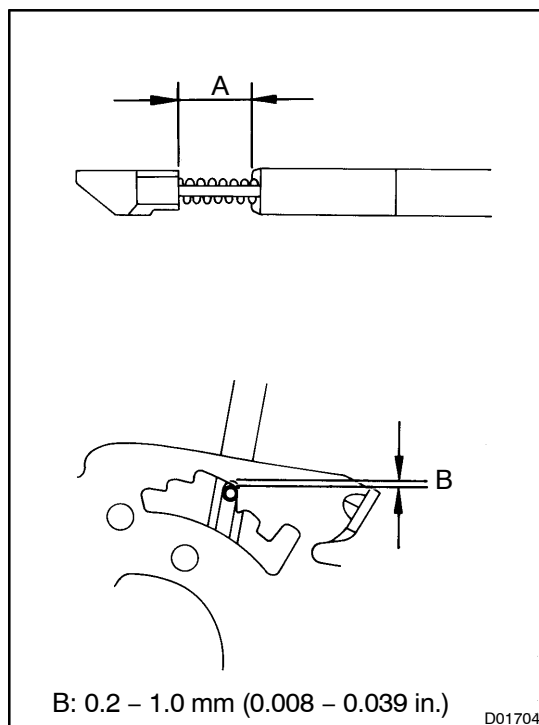

- (g) After assembling the shift lever knob, adjust the distance A by moving the shift lever knob sleeve so that the clearance B between the detent plate and grooved pin is within the standard with the shift lever in N position.

10. INSTALL SHIFT LEVER KNOB**11. INSTALL O/D MAIN SWITCH TERMINAL**

- (a) Connect the 2 O/D main switch terminals to the connector.
- (b) Connect the connector to the shift lever plate.